

ESSEX CURVED BENCH - 83"

ASSEMBLY INSTRUCTIONS

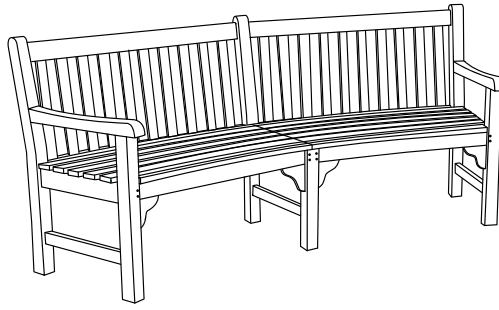

COMPONENTS

① Right Arm Assembly
Quantity: 1

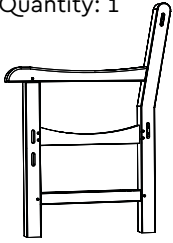

② Left Arm Assembly
Quantity: 1

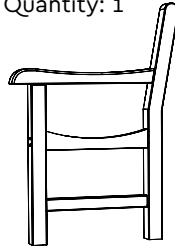

③ Center Brace Assembly
Quantity: 1

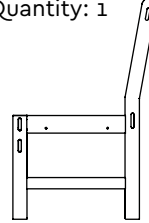

④ Back
Quantity: 1 (Right Shown)
Quantity: 1 (Left)

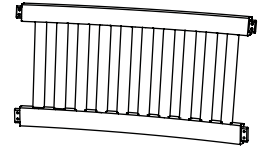

⑤ Seat
Quantity: 1 (Right Shown)
Quantity: 1 (Left)

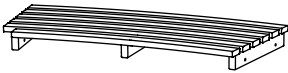

⑥ Front Rail
Quantity: 1 (Right Shown)
Quantity: 1 (Left)



⑦ Right Corner Brace
Quantity: 2



⑧ Left Corner Brace
Quantity: 2

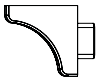

HARDWARE

A Dowels
Quantity: 36



B Phillip-Head Wood Screws
Quantity: 4



C Allen Head Screw
Quantity: 4



D Bolts
Quantity: 2



E Allen Wrench
Quantity: 1

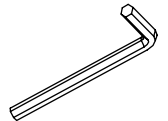

FINISHING ITEMS

Medium Grit Sandpaper

NOTE: If the furniture is going to be placed on a concrete or tile patio, it should first be rinsed well to remove the sawdust that may cause some staining.

NOTE: A hammer and a phillips head screwdriver (not provided) will be needed for the assembly of this bench.

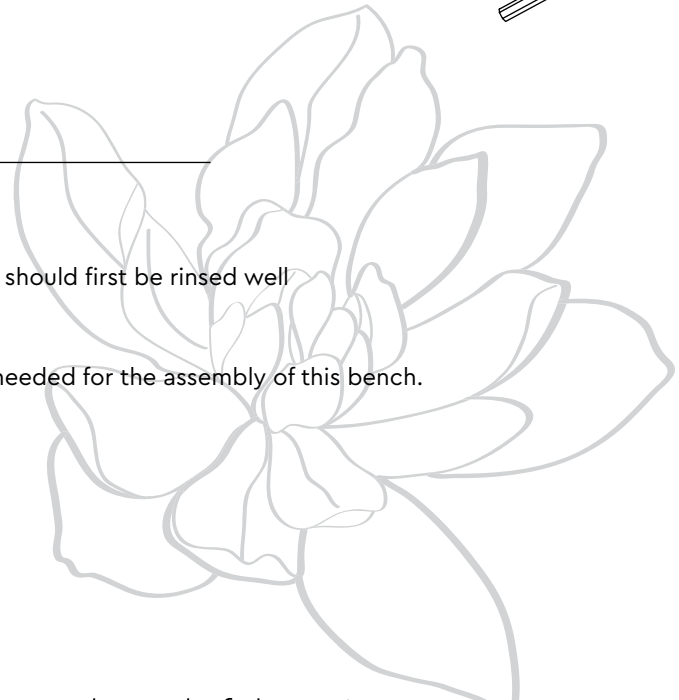

Thoughtful Design **MADE RIGHT**

INSTRUCTIONS

STEP 1

NOTE: We highly recommend the use of two people for assembly of this bench. Do not drive the dowels into place until all components are fitted together. Stand center brace ③ upright. Insert the left back assembly ④ into the holes of the center brace.

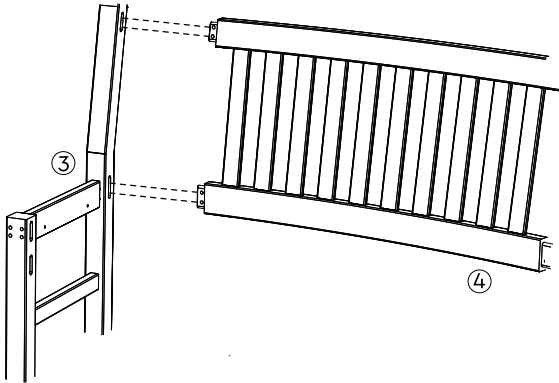

STEP 2

Align the back of the seat support rail of the (left) seat assembly ⑤ with the back assembly.

NOTE: Each slat of the seat assembly overhangs the connecting braces at each end. The slats have a greater overhang at one end. The end with the greater overhang will be at the outside end of the bench.

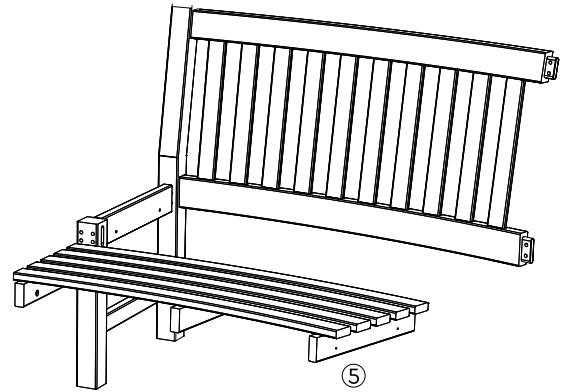

STEP 3

Place (left) front seat rail ⑥ into position as shown.

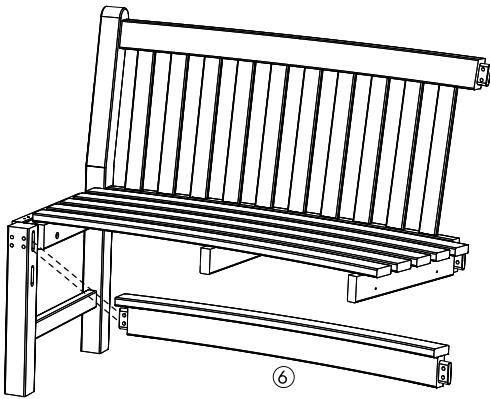

STEP 4

Place (left) arm assembly ② onto the rails of the back assembly and front rail.

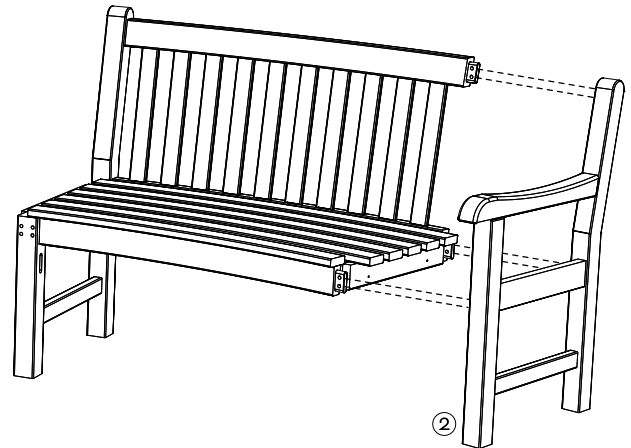

STEP 5

Repeat Steps 1-4 for the right side of the bench. Start with the back, followed by the right seat assembly, right front seat rail and right arm assembly.

STEP 6

Drive thirty two dowels (A) into place as shown.

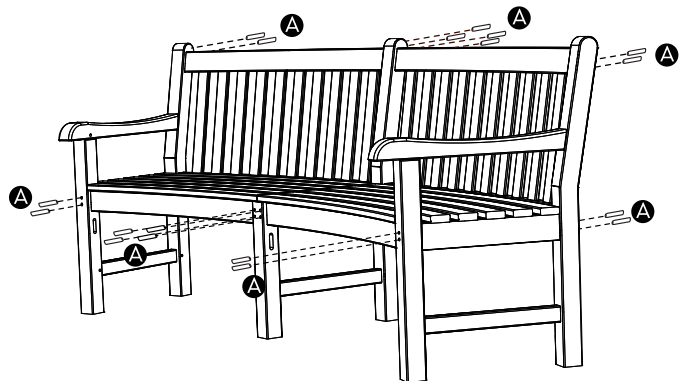

INSTRUCTIONS

STEP 6 (detail)

Back of corner brace.

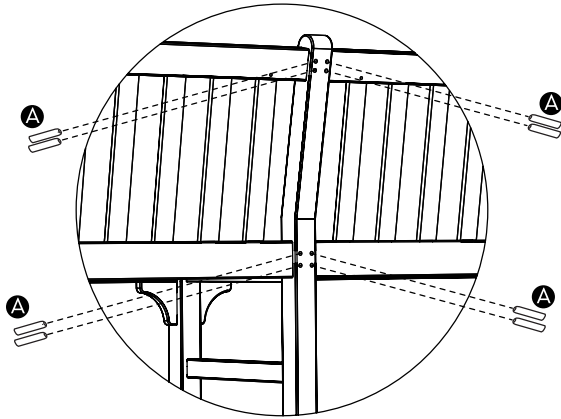

STEP 7

Using two bolts **D**, secure the seat assemblies in the middle of the bench as shown.

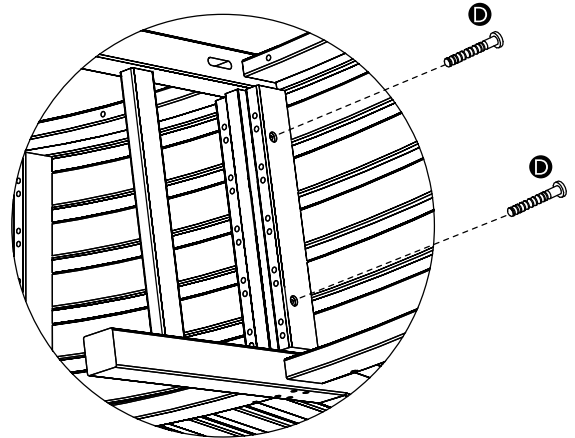

STEP 8

Secure the seat assemblies at each end by driving four wood screws **B** through the end brace on the underside of the seat assemblies into the arm assemblies.

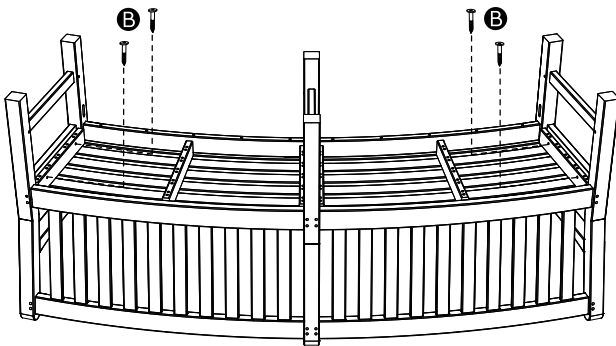

STEP 9

Using the allen wrench provided, secure the four decorative corner braces **7** and **8** using the four allen head screws **C**.

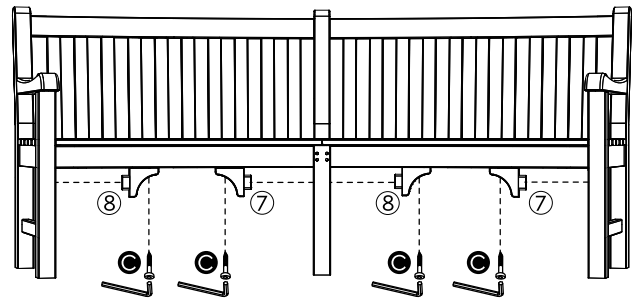

STEP 9 (detail)

Corner braces.

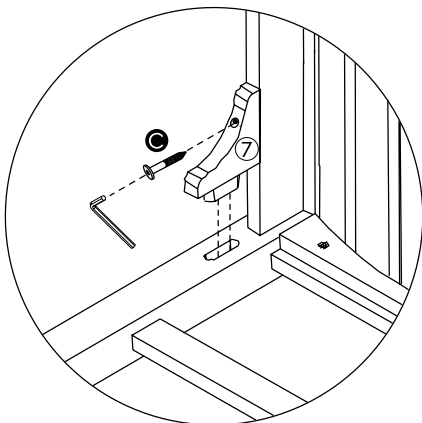

STEP 10

To further secure the corner braces drive 2 dowels **A** into the predrilled holes as shown. Repeat for the remaining corner braces.

